

Parts List for:

RH203V

MODEL C SINGLE-ACTING, HOLLOW CENTER, SPRING RETURN HYDRAULIC CYLINDER Max. Capacity: 20 Tons At 10,186 PSI

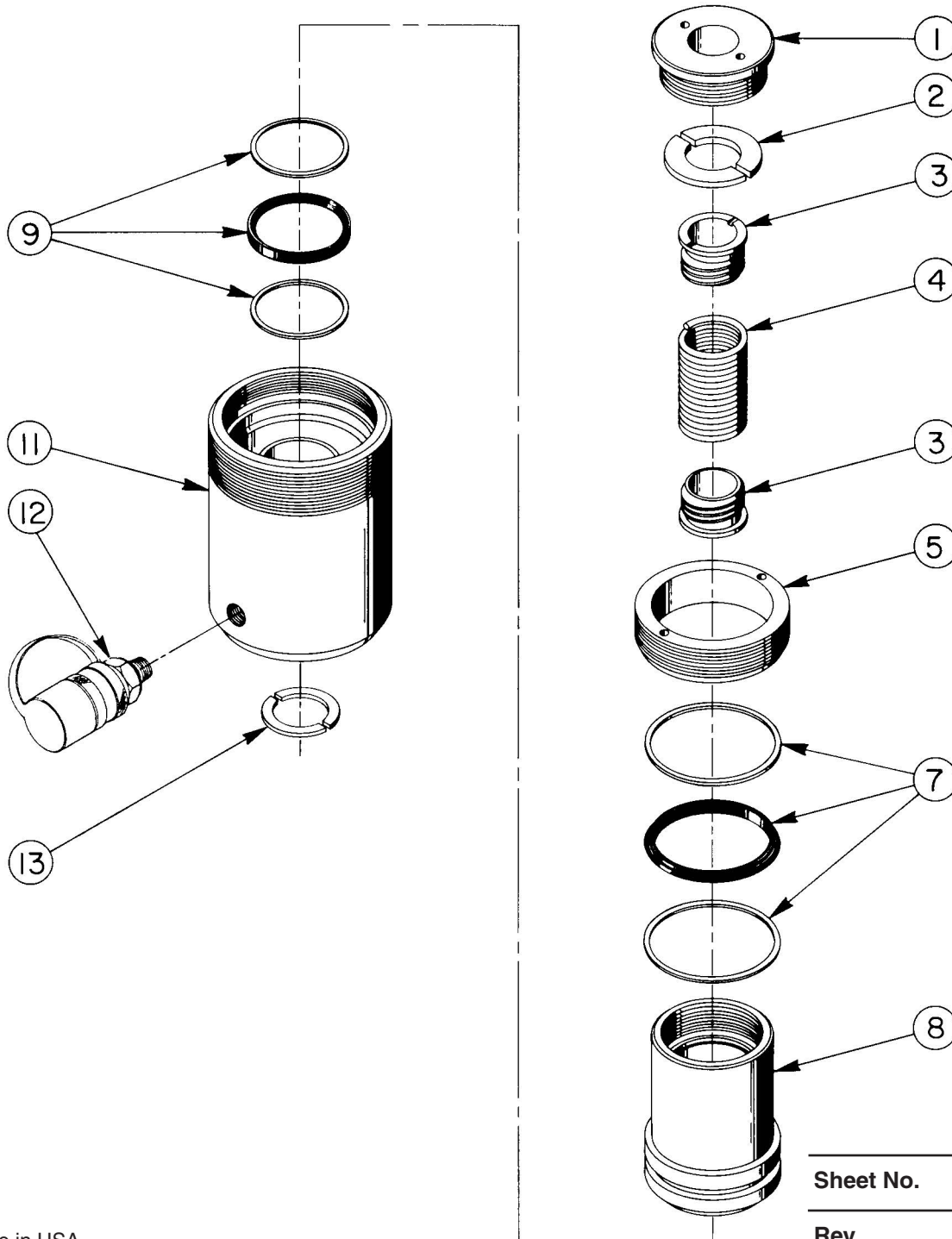

Sheet No. 1 of 1

Rev. Date: 13 Mar. 1997

Parts List, Form No. 101809, Back sheet 1 of 1

| Item No. | Part No. | No. Req'd | Description |
|----------|----------|-----------|--|
| 1 | 28611 | 1 | Insert |
| 2 | 205122 | 2 | Upper Spring Lock |
| 3 | 28608 | 2 | Spring Retainer |
| 4 | 14244 | 1 | Extension Spring |
| 5 | 28607 | 1 | Gland Nut |
| 7 | †19241 | 1 | T-seal & Backup Rings (Smooth side of Backup Ring must be against seal.) |
| 8 | 34111 | 1 | Piston Rod |
| 9 | †19239 | 1 | T-seal & Backup Rings (Smooth side of Backup Ring must be against seal.) |
| 11 | 34157 | 1 | Cylinder/Standpipe Ass'y (Unpainted) |
| 12 | 9796 | 1 | Ram Half Coupler w/Dust Cap |
| 13 | 205121 | 2 | Lower Spring Lock |

PARTS INCLUDED BUT NOT SHOWN

| | | |
|---------|---|--------------------|
| †205724 | 1 | Decal (Viton) |
| 202173 | 1 | Trade Name Decal |
| †19526 | 1 | Seal (For coupler) |



Part numbers marked with a dagger (†) are contained in Repair Kit No. 300222.

Refer to any operating instructions included with this product for detailed information about operation, testing, disassembly, reassembly, and preventive maintenance.

Items found in this parts list have been carefully tested and selected. **Therefore: Use only genuine Power Team replacement parts!**

Additional questions can be directed to our Technical Services Department.